



Nightspot pole luminaires, as floodlights or gobo projectors, can be mounted at any height required. They can be arranged in any way and therefore offer a very wide scope of design. They are available in a range of wattages and distributions for metal halide lamps or with LEDs. Their distinctive design makes them attractive for exterior lighting installations.

Design: Roy Fleetwood

The fixing system ensures a durable and robust installation, at the same time allowing the luminaires to be aimed as required.





Nightspot pole luminaires can be used for the imaginative lighting of public spaces. They can create uniform illumination or be used for highlighting purposes. They can even be combined with gobo projectors in order to project images.

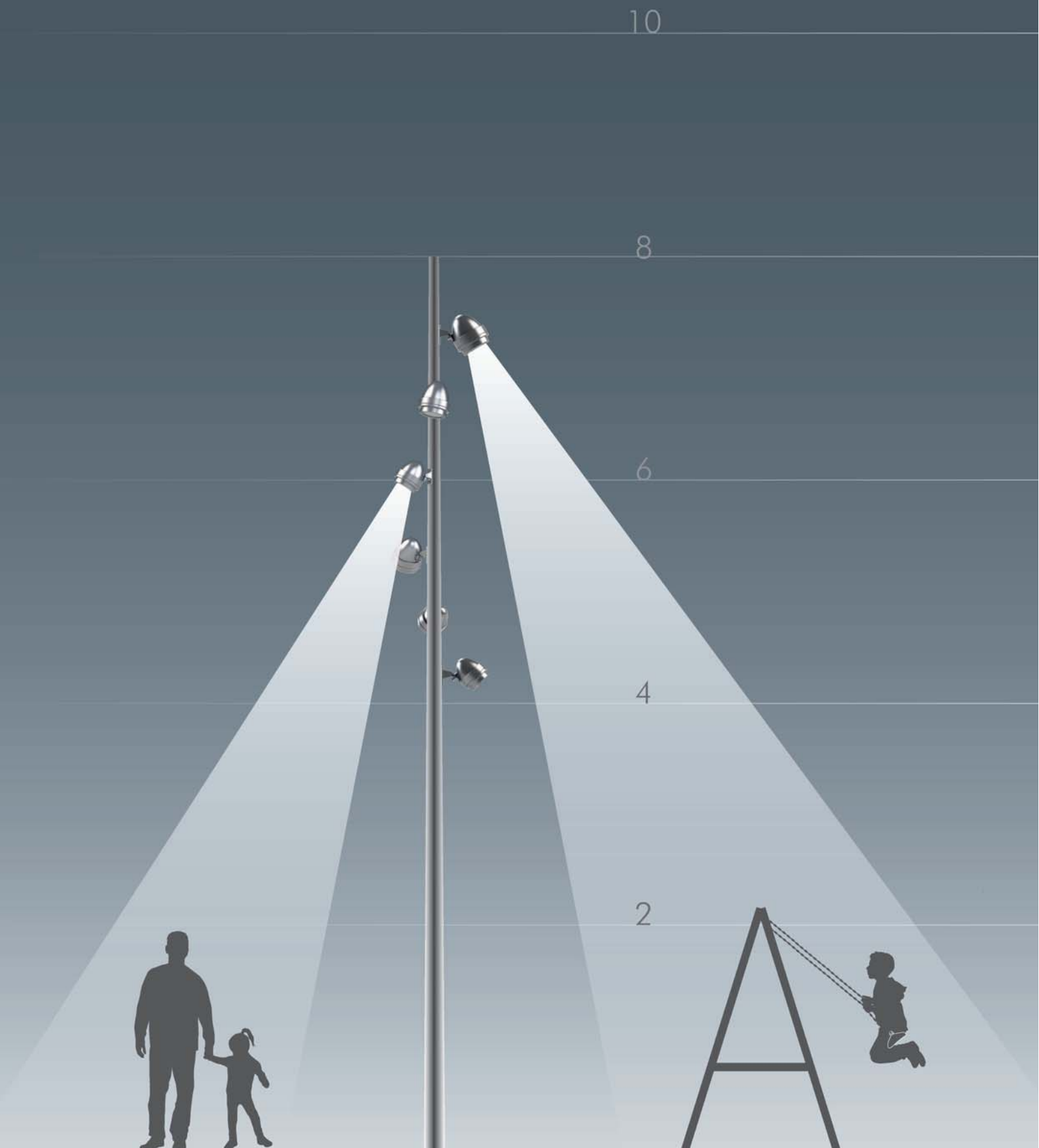





Nightspot A2, pole luminaire

For ceramic metal halide lamps (HIT-TC-CE)
 protection class I, IP65 $\diamond \triangle \triangle$, IK08
 windage area A_w 0.035 m²
 cast aluminium housing, polyester powder coated,
 rotationally symmetrical aluminium reflector,
 all exterior steel parts are stainless steel, tempered
 safety glass, silicon gasket, closure with 4 stainless
 steel screws, for installation on poles \varnothing 60 - 100 mm,
 powder coated aluminium mounting base:
 2 drilled holes \varnothing 9 mm, spacing 105 mm, 1 centre
 hole \varnothing 22 mm, tilt range 100°, swivel range 180°,
 M20 cable gland, integral electronic ballast,
 supplied without lamp

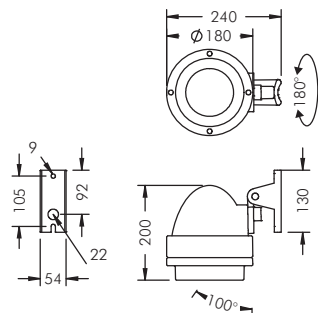

Nightspot A2 20 W, pole luminaire, narrow beam

Part number	Colour	Lamp	Lampholder	Weight	Half beam angle γ
8 984 241 009	black	HIT-TC-CE 20 W	GU6.5	2.5 kg	5°
8 984 261 009	white				
8 984 251 009	silver grey				

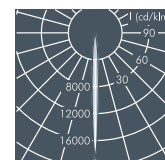
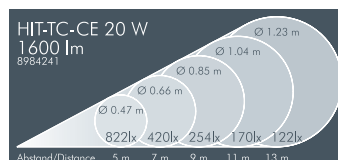

Nightspot A2 35 W, pole luminaire, narrow beam

Part number	Colour	Lamp	Lampholder	Weight	Half beam angle γ
8 985 241 009	black	HIT-TC-CE 35 W	GU6.5	2.5 kg	5°
8 985 261 009	white				
8 985 251 009	silver grey				

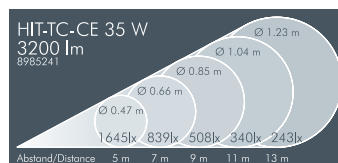

Nightspot A2 20/35 W, pole luminaire, narrow beam

Part number	Description	Half beam angle γ	
		C 0 - 180	C 90 - 270
... .. 079	Luminaire with ribbed glass spreader lense, internally fitted, for linear beam distribution, continuously adjustable through 360°	17°	31°

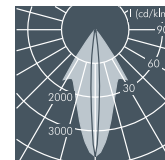
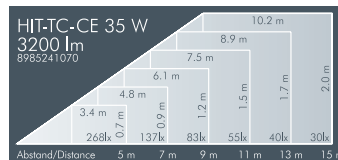

Nightspot A2 20 W, pole luminaire, medium wide beam

Part number	Colour	Lamp	Lampholder	Weight	Half beam angle γ
8 984 242 009	black	HIT-TC-CE 20 W	GU6.5	2.5 kg	11°
8 984 262 009	white				
8 984 252 009	silver grey				

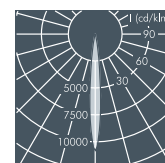
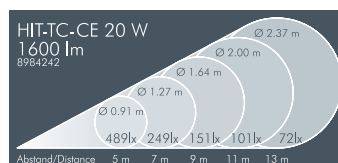

Nightspot A2 35 W, pole luminaire, medium wide beam

Part number	Colour	Lamp	Lampholder	Weight	Half beam angle γ
8 985 242 009	black	HIT-TC-CE 35 W	GU6.5	2.5 kg	11°
8 985 262 009	white				
8 985 252 009	silver grey				

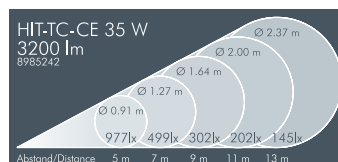

Lamps (see page 332-333)

HIT-TC-CE



Nightspot A2 LED, pole luminaire

With a high performance LED module and integral temperature monitoring device protection class I, IP65 \blacklozenge \blacktriangle \blacktriangle , IK08 windage area A_w 0.035 m² cast aluminium housing, polyester powder coated, rotationally symmetrical aluminium reflector, all exterior steel parts are stainless steel, tempered safety glass, silicon gasket, closure with 4 stainless steel screws, for installation on poles \varnothing 60 - 100 mm, powder coated aluminium mounting base: 2 drilled holes \varnothing 9 mm, spacing 105 mm, 1 centre hole \varnothing 22 mm, tilt range 100°, swivel range 180°, M20 cable gland, integral driver (AC/DC)

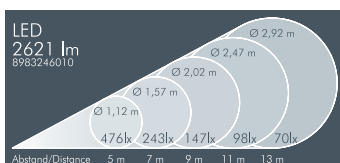
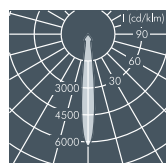
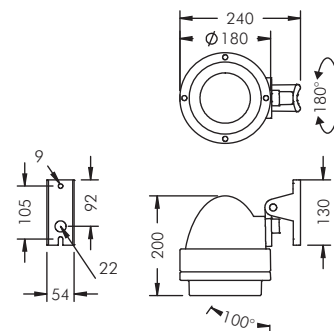

Nightspot A2 LED, pole luminaire, narrow beam

Part number*	Colour	Light source	Weight	Half beam angle γ
8 983 246 019	black	1 x LED module 33 W	2.5 kg	13°
8 983 266 019	white	warm white (3000 K)		
8 983 256 019	silver grey			

*These luminaires are also available with neutral white LED (4000 K) upon request.

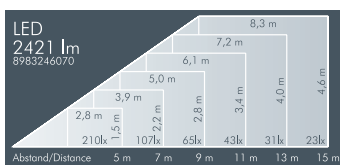
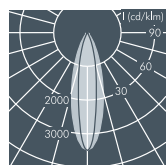
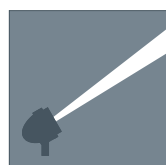

Nightspot A2 LED, pole luminaire, narrow beam

Part number	Description	Half beam angle γ
... .. 079	Luminaire with ribbed glass spreader lens, internally fitted, for linear beam distribution, continuously adjustable through 360°	C 0 - 180 17° C 90 - 270 31°

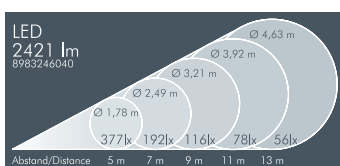
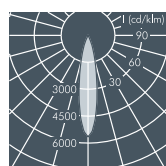

Nightspot A2 LED, pole luminaire, medium wide beam

Part number*	Colour	Light source	Weight	Half beam angle γ
8 983 246 049	black	1 x LED module 33 W	2.5 kg	20°
8 983 266 049	white	warm white (3000 K)		
8 983 256 049	silver grey			

*These luminaires are also available with neutral white LED (4000 K) upon request.

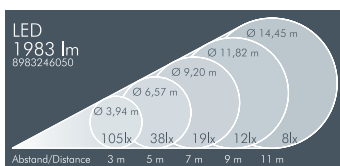
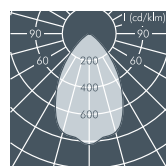

Nightspot A2 LED, pole luminaire, wide beam

Part number*	Colour	Light source	Weight	Half beam angle γ
8 983 246 059	black	1 x LED module 33 W	2.5 kg	67°
8 983 266 059	white	warm white (3000 K)		
8 983 256 059	silver grey			

*These luminaires are also available with neutral white LED (4000 K) upon request.

Part number	Description
8 983 ... 2 ..	Dimmable version (1-10 V)

LED (see page 334)

LEDs, replacement modules available



Nightspot B LED, pole luminaire

With a high performance LED module, integral temperature monitoring device protection class I, IP65 \blacklozenge \blacktriangle \blacktriangle , IK08 windage area AW 0.05 m² cast aluminium housing, polyester powder coated, rotationally symmetrical aluminium reflector, all exterior steel parts are stainless steel, tempered safety glass, silicon gasket, closure with 4 stainless steel screws, for pole diameter \varnothing 60–100 mm, rotatable, polyester powder coated aluminium mounting base: 2 drilled holes \varnothing 9 mm, spacing 105 mm, 1 centre hole \varnothing 22 mm, tilt range 80°, swivel range 180°, M20 cable gland, integral driver (AC/DC)

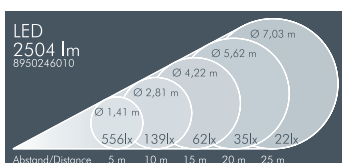
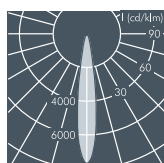
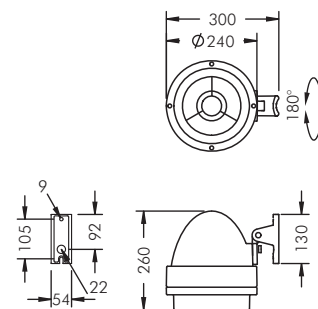

Nightspot B LED, pole luminaire, narrow beam

Part number	Colour	Light source	Weight	Half beam angle γ
8 950 246 019	black	1 x LED module 39 W	5.5 kg	10°
8 950 266 019	white	warm white (3000 K)		
8 950 256 019	silver grey			

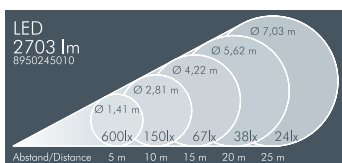
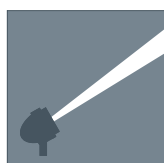

Part number	Colour	Light source	Weight	Half beam angle γ
8 950 245 019	black	1 x LED module 39 W	5.5 kg	10°
8 950 265 019	white	neutral white (4000 K)		
8 950 255 019	silver grey			

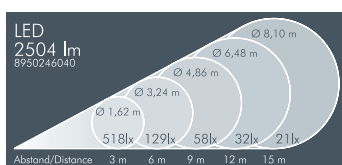
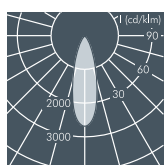

Nightspot B LED, pole luminaire, medium wide beam

Part number	Colour	Light source	Weight	Half beam angle γ
8 950 246 049	black	1 x LED module 39 W	5.5 kg	30°
8 950 266 049	white	warm white (3000 K)		
8 950 256 049	silver grey			

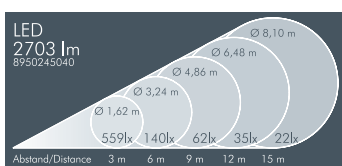

Part number	Colour	Light source	Weight	Half beam angle γ
8 950 245 049	black	1 x LED module 39 W	5.5 kg	30°
8 950 265 049	white	neutral white (4000 K)		
8 950 255 049	silver grey			

Part number	Description
8 950 ... 1 ..	Dimmable version (DALI)
8 950 ... 2 ..	Dimmable version (1-10 V)

LED (see page 334)

LEDs, replacement modules available



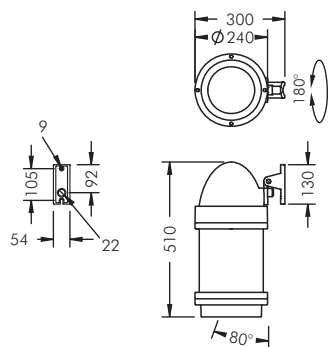

Nightspot B Gobo Projector, pole luminaire

For ceramic metal halide lamps (HIT-CE) protection class I, IP65 \diamond \triangle \triangle , IK08 windage area AWW 0.11 m² cast aluminium housing and aluminium profile, polyester powder coated, projection lens for focusing, holders for gobos and for colour filters, all exterior steel parts are stainless steel, tempered safety glass, silicon gasket, closure with 4 stainless steel screws, for pole diameter \varnothing 60–100 mm, rotatable, polyester powder coated aluminium mounting base, powder coated aluminium mounting bracket with tilt scale: 2 drilled holes \varnothing 9 mm, spacing 105 mm, 1 centre hole \varnothing 22 mm, tilt range 80°, swivel range 180°, M20 cable gland, integral LPF ballast and ignitor, HPF available (see page 330), supplied without lamp

Nightspot B Gobo Projector 70 W, 63 mm focal length

Part number	Colour	Lamp	Lampholder	Weight	Beam angle
8 959 243 009	black	HIT-CE 70 W	G12	10.2 kg	32°
8 959 263 009	white				
8 959 253 009	silver grey				

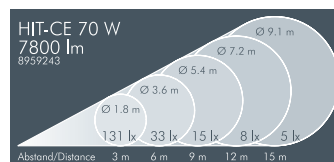

Nightspot B Gobo Projector, 100 W, 63 mm focal length

Part number	Colour	Lamp	Lampholder	Weight	Beam angle
8 959 248 009	black	HIT-CE 100 W	G12	10.2 kg	32°
8 959 268 009	white				
8 959 258 009	silver grey				

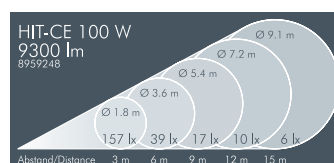

Nightspot B Gobo Projector 70 W, 85 mm focal length

Part number	Colour	Lamp	Lampholder	Weight	Beam angle
8 959 242 009	black	HIT-CE 70 W	G12	10.2 kg	24°
8 959 262 009	white				
8 959 252 009	silver grey				

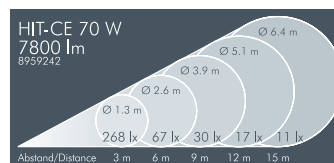

Nightspot B Gobo Projector 100 W, 85 mm focal length

Part number	Colour	Lamp	Lampholder	Weight	Beam angle
8 959 247 009	black	HIT-CE 100 W	G12	10.4 kg	24°
8 959 267 009	white				
8 959 257 009	silver grey				

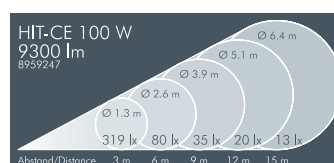

Nightspot B Gobo Projector 70 W, 150 mm focal length

Part number	Colour	Lamp	Lampholder	Weight	Beam angle
8 959 241 009	black	HIT-CE 70 W	G12	10.2 kg	14°
8 959 261 009	white				
8 959 251 009	silver grey				

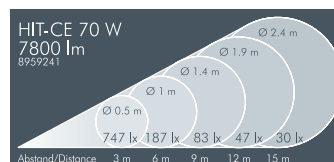

Nightspot B Gobo Projector 100 W, 150 mm focal length

Part number	Colour	Lamp	Lampholder	Weight	Beam angle
8 959 246 009	black	HIT-CE 100 W	G12	10.4 kg	14°
8 959 266 009	white				
8 959 256 009	silver grey				

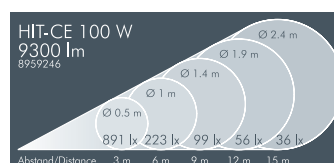

Lamps (see page 332–333)

HIT-CE



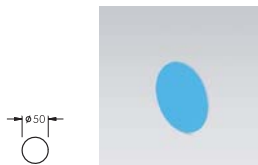

Accessories for Nightspot Gobo Projectors 70/100 W,

63/85/150 mm focal length

Part number	Colour	Description
129 0 551 000	yellow	Dichroic colour filter
129 0 557 000	red	
129 0 553 000	blue	
129 0 558 000	green	

Part number	Description
129 0 257 000	Framer for sharp edges on 3 or 4-sided images



Accessories for Nightspot Gobo Projectors, 63/85/150 mm focal length

Part number	example	Description
129 0 489 000	waves	Standard gobos Ø 50 mm
129 0 490 000	stars	
129 0 491 000	hatch	

Custom made gobos can be produced from Image data in one of the following file formats: **EPS** (min. 300 dpi), **TIF** (min. 300 dpi), **JPG** (in low compression).
Max. image size D on gobo: D = 38 mm (outer diameter gobo 50 mm)

Max. diameter of image, different focal length f, gobo aperture Ø 38 mm

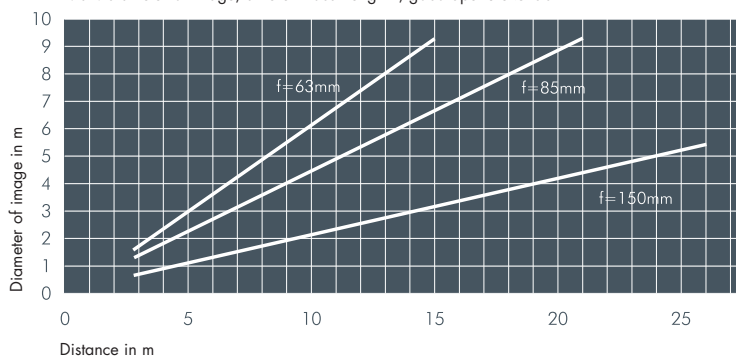

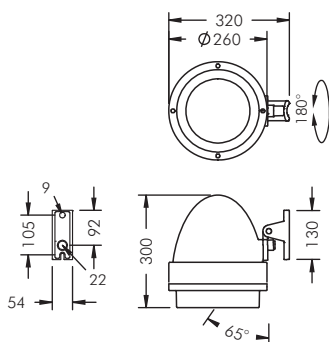

Nightspot B2, pole luminaire (Protection class II)

For metal halide lamps (HIT) and ceramic metal halide lamps (HIT-CE) protection class II, IP65, IK08, windage area AW 0.05 m², cast aluminium housing, polyester powder coated, rotationally symmetrical aluminium reflector, all exterior steel parts are stainless steel, tempered safety glass, silicon gasket, closure with 4 stainless steel screws, for pole diameter Ø 60–100 mm, rotatable, polyester powder coated aluminium mounting base: 2 drilled holes Ø 9 mm, spacing 105 mm, 1 centre hole Ø 22 mm, tilt range 65°, swivel range 180°, M20 cable gland, integral LPF ballast and ignitor, HPF available (see page 330), supplied without lamp

Nightspot B2 35 W, pole luminaire, narrow beam

Part number	Colour	Lamp	Lampholder	Weight	Half beam angle γ
8 971 241 009	black	HIT-CE 35 W	G12	7.0 kg	7°
8 971 261 009	white				
8 971 251 009	silver grey				

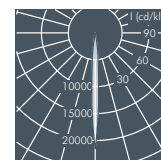
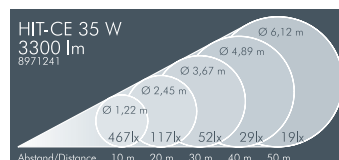

Nightspot B2 70 W, pole luminaire, narrow beam

Part number	Colour	Lamp	Lampholder	Weight	Half beam angle γ
8 973 241 009	black	HIT 70 W	G12	7.4 kg	7°
8 973 261 009	white	HIT-CE 70 W			
8 973 251 009	silver grey				

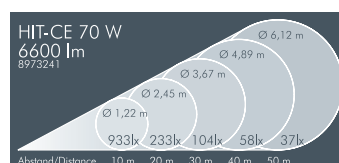

Accessories for Nightspot B2 35/70 W, narrow beam

Part number	Description	Half beam angle γ
129 0 492 000	Ribbed glass spreader lens , internally fitted, for linear beam distribution, continuously adjustable through 360°	C 0 – 180 C 90 – 270
		8° 30°

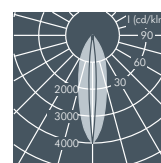
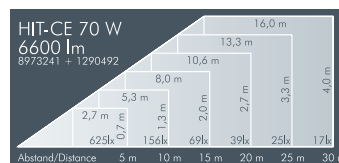

Nightspot B2 35 W, pole luminaire, medium wide beam

Part number	Colour	Lamp	Lampholder	Weight	Half beam angle γ
8 971 242 009	black	HIT-CE 35 W	G12	7.0 kg	38°
8 971 262 009	white				
8 971 252 009	silver grey				

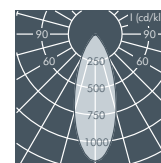
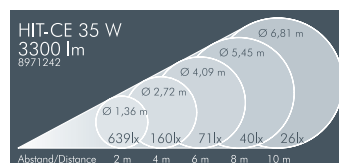

Nightspot B2 70 W, pole luminaire, medium wide beam

Part number	Colour	Lamp	Lampholder	Weight	Half beam angle γ
8 973 242 009	black	HIT 70 W	G12	7.4 kg	38°
8 973 262 009	white	HIT-CE 70 W			
8 973 252 009	silver grey				

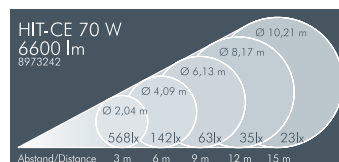

Nightspot B2 35 W, pole luminaire, wide beam

Part number	Colour	Lamp	Lampholder	Weight	Half beam angle γ
8 971 243 009	black	HIT-CE 35 W	G12	7.4 kg	60°
8 971 263 009	white				
8 971 253 009	silver grey				

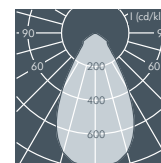
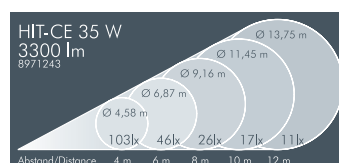

Nightspot B2 70 W, pole luminaire, wide beam

Part number	Colour	Lamp	Lampholder	Weight	Half beam angle γ
8 973 243 009	black	HIT 70 W	G12	7.4 kg	60°
8 973 263 009	white	HIT-CE 70 W			
8 973 253 009	silver grey				

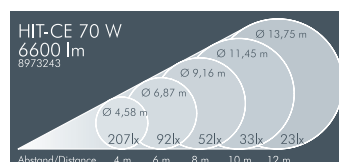

Lamps [see page 332–333]

HIT HIT-CE



Nightspot B2, pole luminaire, wide beam
(Protection class II)

For metal halide lamps (HIT) and ceramic metal halide lamps (HIT-CE) protection class II, IP65, IK08 windage area A_W 0.05 m² cast aluminium housing, polyester powder coated, aluminium reflector, all exterior steel parts are stainless steel, tempered safety glass, silicon gasket, closure with 4 stainless steel screws, for pole diameter Ø 60–100 mm, rotatable, polyester powder coated aluminium mounting base: 2 drilled holes Ø 9 mm, spacing 105 mm, 1 centre hole Ø 22 mm, tilt range 65°, swivel range 180°, M20 cable gland, integral LPF ballast and ignitor, HPF available (see page 330), supplied without lamp

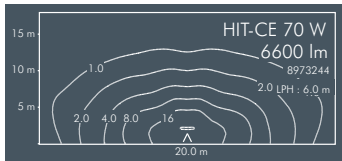
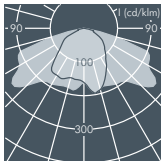
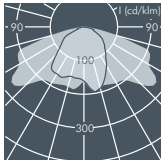
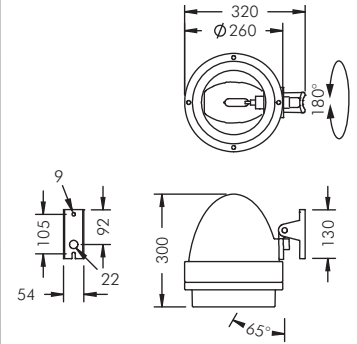

Nightspot B2 35 W, pole luminaire, wide beam

Part number	Colour	Lamp	Lampholder	Weight	Half beam angle γ	
					C 0 – 180	C 90 – 270
8 971 244 009	black	HIT-CE 35 W	G12	7.0 kg	82°	145°
8 971 264 009	white					
8 971 254 009	silver grey					

Nightspot B2 70 W, pole luminaire, wide beam

Part number	Colour	Lamp	Lampholder	Weight	Half beam angle γ	
					C 0 – 180	C 90 – 270
8 973 244 009	black	HIT 70 W	G12	7.4 kg	82°	145°
8 973 264 009	white	HIT-CE 70 W				
8 973 254 009	silver grey					

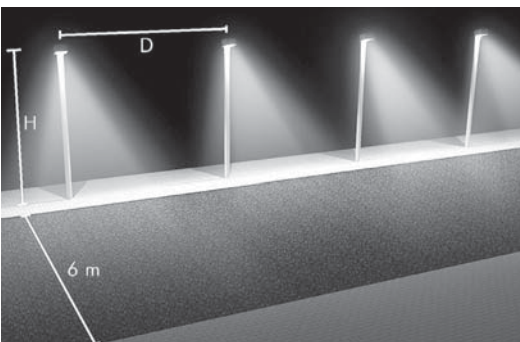

Typical illumination levels and uniformity values

	HIT / HIT-CE	
	35 W	70 W
H	5 m	6 m
D	20 m	24 m
D/H	4	4
Em	7 lx	11 lx
E_{min}/E_m	0.36	0.38

Lamps (see page 332–333)

HIT HIT-CE



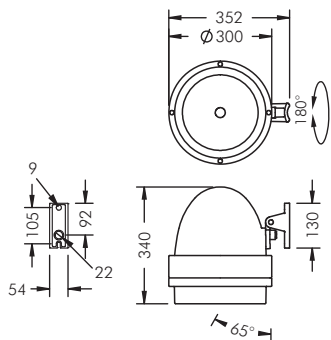

Nightspot C, pole luminaire

For metal halide lamps (HIT) and ceramic metal halide lamps (HIT-CE) protection class I, IP65 IK08 windage area AWW 0.08 m² cast aluminium housing, polyester powder coated, rotationally symmetrical aluminium reflector, all exterior steel parts are stainless steel, tempered safety glass, silicon gasket, closure with 4 stainless steel screws, for pole diameter Ø 60–100 mm, rotatable, polyester powder coated aluminium mounting base: 2 drilled holes Ø 9 mm, spacing 105 mm, 1 centre hole Ø 22 mm, tilt range 65°, swivel range 180°, M20 cable gland, integral LPF ballast and ignitor, HPF available (see page 330), supplied without lamp

Nightspot C, pole luminaire, narrow beam

Part number	Colour	Lamp	Lampholder	Weight	Half beam angle γ
8 954 241 009	black	HIT 150 W	G12	9.6 kg	5°
8 954 261 009	white	HIT-CE 150 W			
8 954 251 009	silver grey				

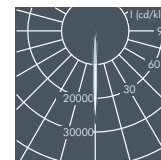
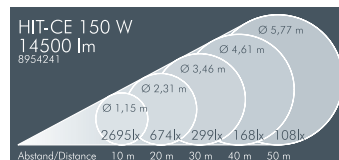

Accessories for Nightspot C, pole luminaire, narrow beam

Part number	Description	Half beam angle γ
129 0 284 000	Ribbed glass , internally fitted, for linear beam distribution, continuously adjustable through 360°	C 0 – 180 8° C 90 – 270 30°

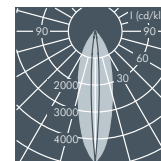
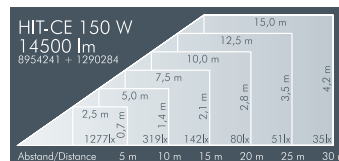

Nightspot C, pole luminaire, medium wide beam

Part number	Colour	Lamp	Lampholder	Weight	Half beam angle γ
8 954 242 009	black	HIT 150 W	G12	9.6 kg	32°
8 954 262 009	white	HIT-CE 150 W			
8 954 252 009	silver grey				

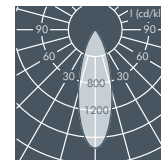
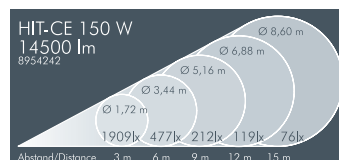

Nightspot C, pole luminaire, wide beam

Part number	Colour	Lamp	Lampholder	Weight	Half beam angle γ
8 954 243 009	black	HIT 150 W	G12	9.6 kg	60°
8 954 263 009	white	HIT-CE 150 W			
8 954 253 009	silver grey				

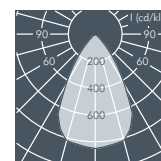
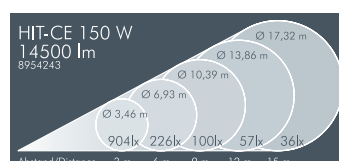

Accessories Nightspot A2, B

Part number A2	Part number B	Colour	Description
129 0 578 940	129 0 320 940	black	Cowl , stainless steel, to avoid lateral glare
129 0 578 960	129 0 320 960	white	
129 0 578 950	129 0 320 950	silver grey	

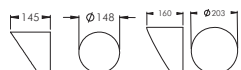

Accessories Nightspot B2, C

Part number B2	Part number C	Colour	Description
129 0 493 940	129 0 321 940	black	Cowl , stainless steel, to avoid lateral glare
129 0 493 960	129 0 321 960	white	
129 0 493 950	129 0 321 950	silver grey	

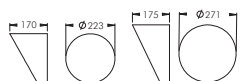

Accessories Nightspot B, B2, C

Part number	Luminaire	Description	Half beam angle γ	
			narrow beam	medium wide beam
129 0 272 000	B	Prismatic glass , for diffused light distribution	19°	54°
129 0 494 000	B2		19°	54°
129 0 282 000	C		19°	39°

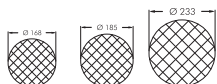

Accessories Nightspot A2

Part number	Description	Half beam angle γ (narrow beam)			
		LED		20/35 W	
129 0 580 000	Ribbed glass , internally fitted, for linear beam control, continuously adjustable 360°	C 0-180	C 90-270	C 0-180	C 90-270
		17°	31°	8°	38°



Accessories Nightspot B, B2, C

Part number	Luminaire	Description	Half beam angle γ			
			narrow beam		medium wide beam	
129 0 274 000	B	Ribbed glass , internally fitted, for linear beam control, continuously adjustable 360°	C 0-180	C 90-270	C 0-180	C 90-270
129 0 492 000	B2		8°	30°	52°	77°
129 0 284 000	C		8°	30°	32°	64°
			8°	30°	52°	77°

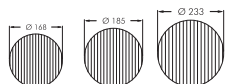

Accessories Nightspot A2 20/35 W (HIT), medium wide beam

Part number	Description
129 0 582 000	Rotational louvre , internally fitted, to reduce lateral glare, for mounting on front of floodlight



Accessories Nightspot B, B2, C

Part number	Luminaire	Description
129 0 270 940*	B	Glare shield , internally fitted, to reduce lateral glare, for mounting on front of floodlight
129 0 495 940	B2	
129 0 280 940	C	

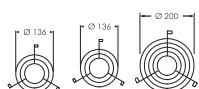

* Not suitable for Nightspot B LED.

Accessories Nightspot A2 LED, medium wide beam

Part number	Description
129 0 589 000	Glare shield , internally fitted, to reduce lateral glare, for mounting on front of floodlight



Accessories Nightspot B, B2, C

Part number	Luminaire	Description
129 0 297 000*	B	Glare shield , internally fitted, to reduce lateral glare, for mounting on front of floodlight
129 0 496 000	B2	
129 0 298 000	C	



* Not suitable for Nightspot B LED.

Accessories Nightspot A2, B, B2, C

Part number A2*	Part number B	Colour	Description
129 0 581 000	129 0 271 000	yellow	Colour filter , internally fitted
129 0 587 000	129 0 277 000	red	
129 0 583 000	129 0 273 000	blue	
129 0 588 000	129 0 278 000	green	

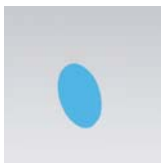

*Dichroic glass colour filter

Part number B2	Part number C	Colour	Description
129 0 501 000	129 0 281 000	yellow	Colour filter , internally fitted
129 0 507 000	129 0 287 000	red	
129 0 503 000	129 0 283 000	blue	
129 0 508 000	129 0 288 000	green	

