

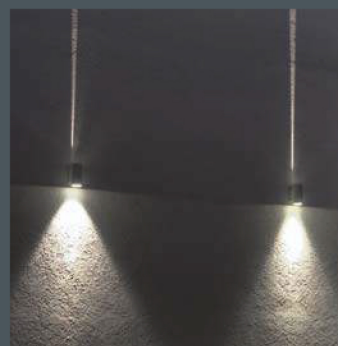

The Twin EL series is equipped with 2 reflectors which produce a conical light beam up and down. Alternatively these luminaires can be supplied with a single reflector and a lense system for creating light band effects. LED luminaires are available with optics for various different light distributions which can be combined with each other.

Sharp-edged light band effects (which may be coloured if required) created by the lense system (only for Twin EL C, the brightness depends on the reflective characteristics of the façade).



Twin EL makes various lighting effects possible: depending on the texture and the reflection characteristics of the façade, either luminaires with a double reflector or those with a pencil beam on the upper side can be used. The appearance of a building at night can be substantially enhanced by using these products.

Twin EL A

With high performance LEDs,
 CRI: > 80, Colour tolerance: max. 2 SDCM
 Service life: L90/B10 > 50 000 h
 protection class I, IP44 
 corrosion-resistant die cast aluminium housing AlSi12,
 polyester powder coated,
 all exterior steel parts are stainless steel,
 tempered safety glasses, silicon gasket,
 closure with 4 stainless steel screws, wall box:
 2 drilled holes \varnothing 6.5 mm, spacing 60 mm,
 2 cable entries up to \varnothing 12 mm,
 for recessed or surface mounted cable,
 for vertical installation only,
 integral driver (AC/DC)

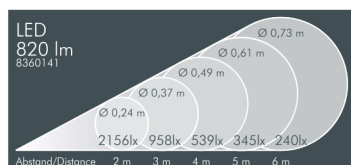
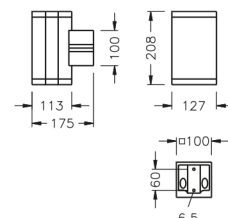

Twin EL A, narrow beam

| Part number | Colour | Light source | Luminous flux | Optics | Beam angle γ (FWHM) | |
|----------------------|-------------|---------------------|---------------|------------------|----------------------------|------|
| | | | | | up | down |
| 8 360 141 009 | black | 8 x LED 1.5 W | 820 lm | narrow beam up | 7° | 7° |
| 8 360 161 009 | white | warm white (3000 K) | | narrow beam down | | |
| 8 360 151 009 | silver grey | | | | | |

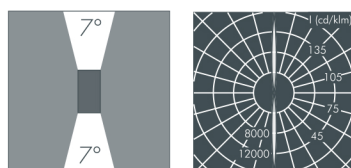

| Part number | Colour | Light source | Luminous flux | Optics | Beam angle γ (FWHM) | |
|----------------------|-------------|------------------------|---------------|------------------|----------------------------|------|
| | | | | | up | down |
| 8 360 747 009 | black | 8 x LED 1.5 W | 861 lm | narrow beam up | 7° | 7° |
| 8 360 767 009 | white | neutral white (4000 K) | | narrow beam down | | |
| 8 360 757 009 | silver grey | | | | | |

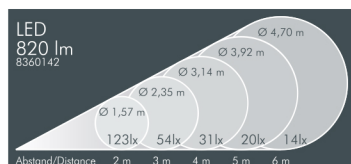

Twin EL A, narrow/wide beam

| Part number | Colour | Light source | Luminous flux | Optics | Beam angle γ (FWHM) | |
|----------------------|-------------|---------------------|---------------|----------------|----------------------------|------|
| | | | | | up | down |
| 8 360 142 009 | black | 8 x LED 1.5 W | 820 lm | narrow beam up | 7° | 45° |
| 8 360 162 009 | white | warm white (3000 K) | | wide beam down | | |
| 8 360 152 009 | silver grey | | | | | |

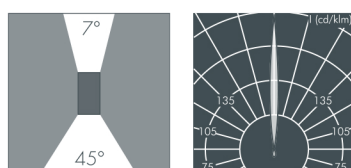

| Part number | Colour | Light source | Luminous flux | Optics | Beam angle γ (FWHM) | |
|----------------------|-------------|----------------------|---------------|----------------|----------------------------|------|
| | | | | | up | down |
| 8 360 748 009 | black | 8 x LED 1.5 W | 861 lm | narrow beam up | 7° | 45° |
| 8 360 768 009 | white | neutralweiß (4000 K) | | wide beam down | | |
| 8 360 758 009 | silver grey | | | | | |

LED (see page 185)

Luminaires available in 2700 K and other colour temperatures on request



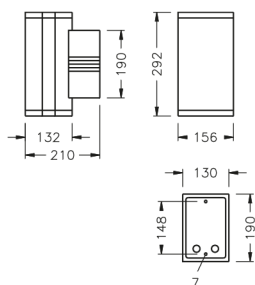

Twin EL C

For ceramic metal halide lamps (HIT-CE)
 protection class I, IP44 ▲
 corrosion-resistant die cast aluminium housing AlSi12,
 polyester powder coated,
 aluminium double reflector (adjustable lampholder) or
 single reflector with lens (adjustable),
 all exterior steel parts are stainless steel,
 tempered safety glasses, silicon gasket,
 closure with 4 stainless steel screws, wall box:
 2 drilled holes \varnothing 7 mm, spacing 148 mm,
 2 cable entries up to \varnothing 12 mm,
 for recessed or surface mounted cable,
 for vertical installation only,
 integral LPF ballast and ignitor,
 HPF available on request (see page 184),
 supplied without lamp

Twin EL C with double reflector

| Part number* | Colour | Lamp | Lampholder | Weight | Optics | Beam angle γ (FWHM) | |
|----------------------|-------------|-------------|------------|--------|------------------|----------------------------|-------|
| | | | | | | Reflector | Lense |
| 8 350 043 009 | black | HIT-CE 35 W | G12 | 4.8 kg | double reflector | 12° – 26° | – |
| 8 350 063 009 | white | | | | | | |
| 8 350 053 009 | silver grey | | | | | | |
| 8 355 045 009 | black | HIT-CE 70 W | | 5.1 kg | | | |
| 8 355 065 009 | white | | | | | | |
| 8 355 055 009 | silver grey | | | | | | |

*Also available as up or downlight only.

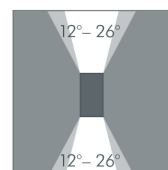
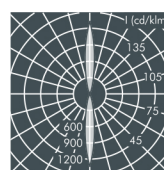
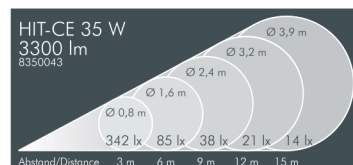

Twin EL C with lense and reflector

| Part number* | Colour | Lamp | Lampholder | Weight | Optics | Beam angle γ (FWHM) | |
|----------------------|-------------|-------------|------------|--------|-----------------------------|----------------------------|-------|
| | | | | | | Reflector | Lense |
| 8 352 043 009 | black | HIT-CE 35 W | G12 | 4.8 kg | lense up, reflector down | 16° – 23° | 1° |
| 8 352 063 009 | white | | | | | | |
| 8 352 053 009 | silver grey | | | | | | |
| 8 357 045 009 | black | HIT-CE 70 W | | 5.1 kg | | | |
| 8 357 065 009 | white | | | | | | |
| 8 357 055 009 | silver grey | | | | | | |

*Also available as up or downlight only.

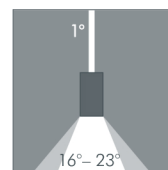
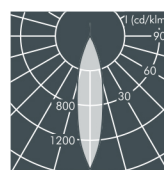
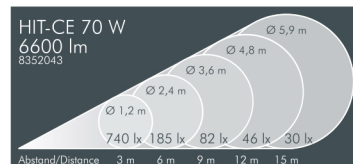

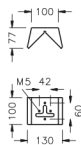

Accessories Twin EL A

| Part number | Colour | Description |
|----------------------|-------------|--|
| 127 0 098 940 | black | Corner fixing bracket , aluminium, polyester powder coated, for mounting floodlights on 90° corners |
| 127 0 098 960 | white | |
| 127 0 098 950 | silver grey | |

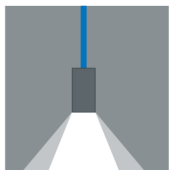
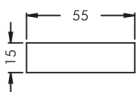

Accessories Twin EL C

| Part number | Colour | Description |
|----------------------|--------|---|
| 123 0 201 910 | yellow | Dichroic glass colour filters , to create coloured light band effects, for retro-fitting |
| 123 0 201 970 | red | |
| 123 0 201 930 | blue | |
| 123 0 201 980 | green | |