

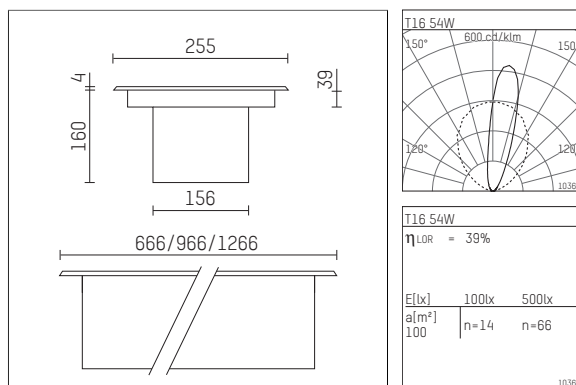

071 044 12 902 | stainless steel

hi.vertical
inground luminaire
T16 | 54 W G5



- inground luminaire hi.vertical
- for mounting into separate in-ground housing
- for optimal illumination of vertical facades
- for T16 54 W
- socket: G5
- asymmetrical light distribution
- Double louver mirror system
- depending on application, suitable for facade heights of up to 50m
- the "Constant" T16 lamp from Osram is recommended for exteriors
- reflector of aluminium, silver anodised
- build in ballast, electronic
- power supply: supply cord, H07RN-F 3x1,5 mm², Länge: 1000 mm
- cable entry M20x1,5
- housing of aluminium and die cast aluminium
- antislip safety glass (R12), clear
- ceiling frame of stainless steel
- length: 1266 mm, width: 255 mm
- recessing depth: 160 mm
- load capacity 1000 kg or 3000 kg with separate installation housing or housing for concrete
- weight: 27,0 kg
- protection rating: IP67
- protection class I
- 5 years Hoffmeister warranty
- colour: stainless steel
- 071 044 12 902

- Overview of accessories on the following page / s

071 044 12 902
accessory**Optional accessories**

description accessory general	dimensions in mm	item number	pic.-No.
housing for concrete cast for ground recessed luminaire hi.vertical	LxWxH: 1400 x 232 x 199	079 022 00 000	01
in-ground housing for ground recessed luminaire hi.vertical	LxWxH: 1400 x 290 x 199	079 049 00 000	02

