

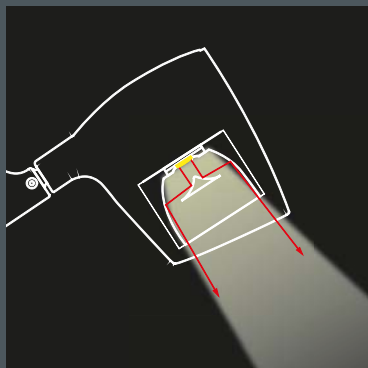

The innovative Monospot+ luminaires are a further development of the Monospot series. With their distinct design the floodlights become features in landscape architecture and in public spaces. By combining external cowls and indirect reflectors excellent glare control is achieved. The luminaires can be controlled and monitored remotely via a Zhaga-18 interface.



Without any direct glare, the light of the LED module is guided onto a primary and secondary reflector. The result of this indirect optical design is perfect glare control combined with high efficiency.

The luminaires are equipped with a turn-and-tilt pole mounting system. They are available either with a mounting base or with an extended arm. By combining these two versions, interesting design options for pole configurations are created. The large choice of different light distributions makes precise illumination of floor areas possible.

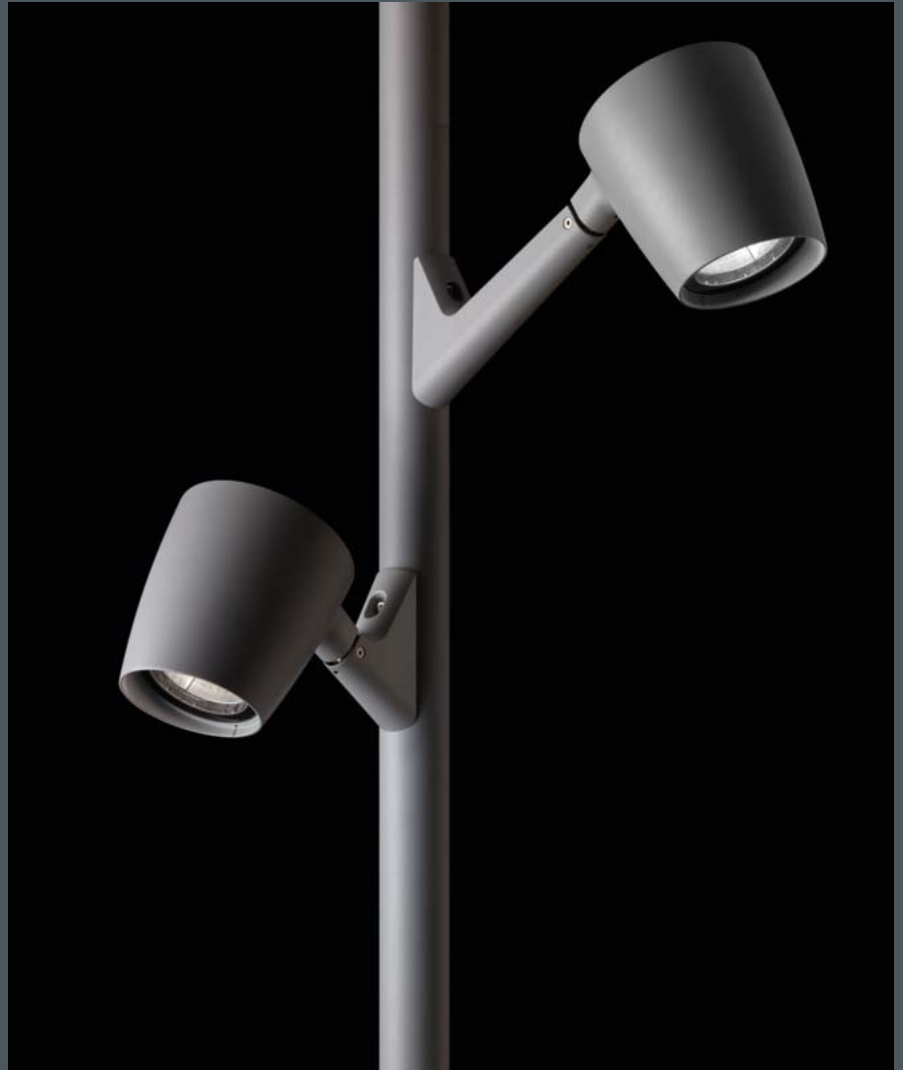

Europaplatz, Tübingen (Germany)
Lighting design: Vogtpartner, Switzerland





Monospot+ pole luminaire

With high performance LED module (Zhaga), integral temperature monitoring device, CRI: > 80, Colour tolerance: 2 SDCM Service life: L80/B10 > 50 000 h protection class I or II, IP65 \diamond \triangle \triangle , IK08 windage area AW 0.049 m² corrosion-resistant die cast aluminium housing AlSi12, polyester powder coated, highly efficient aluminium reflector or PMMA lens (Street Optic), all exterior steel parts are stainless steel, tempered safety glass, silicon gasket, closure with 3 stainless steel screws, tiltable base made of powder coated aluminium, mounting base: 2 drilled holes \varnothing 8.5 mm, spacing 42 mm, 1 centre hole \varnothing 20 mm, tilt range 33°, swivel range 360°, M20 cable gland, integral driver (AC/DC)

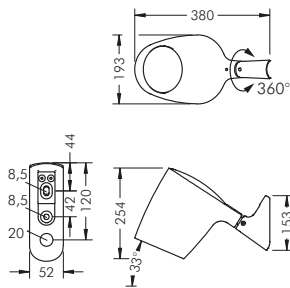

Monospot+, narrow beam

Part number	Colour	Weight	Light source	Luminous flux	Beam angle γ (FWHM)
8 996 246 019	black	4.1 kg	1 x LED module 53 W warm white (3000 K)	4453 lm	10°
8 996 266 019	white				
8 996 256 019	silver grey				

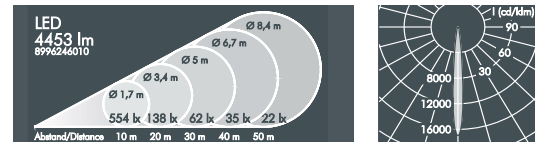

Monospot+, linear beam spread, vertical

Part number	Colour	Weight	Light source	Luminous flux	Beam angle γ (FWHM)
8 996 246 029	black	4.1 kg	1 x LED module 53 W warm white (3000 K)	4230 lm	C 0 – 180
8 996 266 029	white	C 90 – 270			
8 996 256 029	silver grey	37°			12°

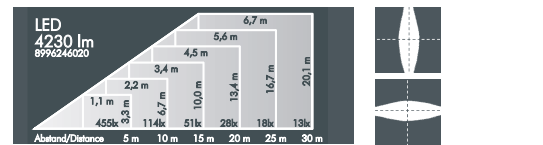

... 3. Luminaire with linear beam spread, horizontal

Monospot+, linear beam spread, rotatable

Part number	Colour	Description	Luminous flux	Beam angle γ (FWHM)
8 996 246 079	black	Luminaire with external ribbed glass spreader lens, continuously adjustable through 360° from outside the luminaire	3794 lm	C 0 – 180
8 996 266 079	white			C 90 – 270
8 996 256 079	silver grey			37°

Weight 4.2 kg

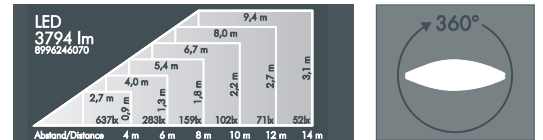

Monospot+, medium wide beam

Part number	Colour	Weight	Light source	Luminous flux	Beam angle γ (FWHM)
8 996 246 049	black	4.1 kg	1 x LED module 53 W warm white (3000 K)	4447 lm	30°
8 996 266 049	white				
8 996 256 049	silver grey				

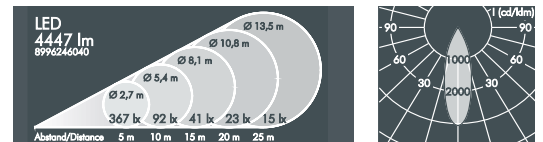

Monospot+, wide beam

Part number	Colour	Weight	Light source	Luminous flux	Beam angle γ (FWHM)
8 996 246 059	black	4.1 kg	1 x LED module 53 W warm white (3000 K)	4523 lm	53°
8 996 266 059	white				
8 996 256 059	silver grey				

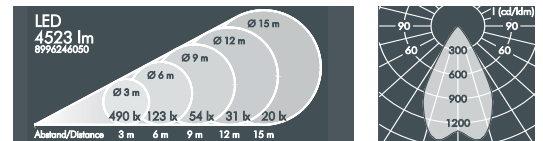

Monospot+, asymmetrical beam

Part number	Colour	Weight	Light source	Luminous flux	Main beam angle γ
8 996 246 099	black	4.9 kg	1 x LED module 53 W warm white (3000 K)	2966 lm	38°
8 996 266 099	white				
8 996 256 099	silver grey				

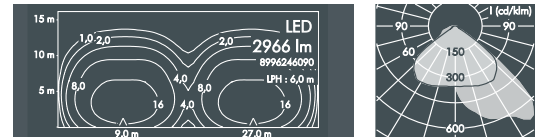

Monospot+, Street Optic

Part number	Colour	Weight	Light source	Luminous flux	Beam angle γ (FWHM)
8 996 246 089	black	4.9 kg	1 x LED module 53 W warm white (3000 K)	3764 lm	C 0 – 180
8 996 266 089	white	C 90 – 270			
8 996 256 089	silver grey	117°			88°

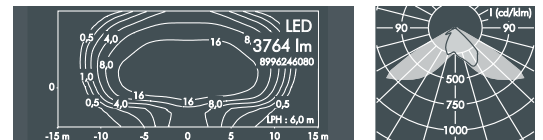

Part number	Description
... 5 ...	Monospot+ (27 W)
... 7 ...	Protection class II luminaire (27 W)
... 8 ...	Protection class II luminaire (53 W)
... 7 ...	Luminaire with warm white LED module (2700 K)
... 8 ...	Luminaire with warm white LED module (2200 K)
... 1 ...	Dimmable luminaire (DALI)
... 2 ...	Dimmable luminaire (DALI D4i)
... 3 ...	Luminaire with Zhaga-18 interface

Luminaires available in other colour temperatures upon request

Monospot+ pole luminaire with secondary reflector

With high performance LED module (Zhaga), integral temperature monitoring device, CRI: > 80, Colour tolerance: 2 SDCM
 Service life: L80/B10 > 50 000 h
 protection class I or II, IP65 , IK08
 windage area AW 0.049 m²
 corrosion-resistant die cast aluminium housing AlSi12, polyester powder coated, enhanced glare control with primary and secondary reflector, all exterior steel parts are stainless steel, tempered safety glass, silicon gasket, closure with 3 stainless steel screws, tiltable base made of powder coated aluminium, mounting base:
 2 drilled holes \varnothing 8.5 mm, spacing 42 mm,
 1 centre hole \varnothing 20 mm, tilt range 33°, swivel range 360°, M20 cable gland, integral driver (AC/DC)

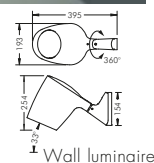
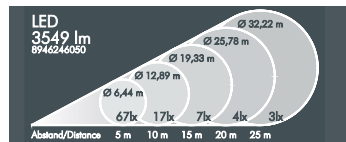
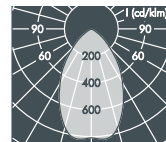
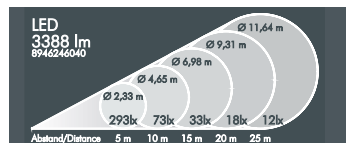
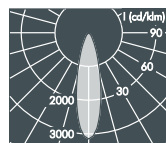
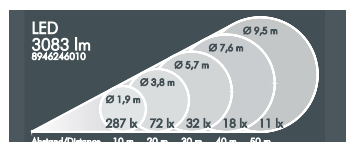
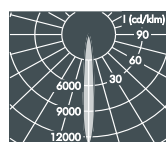
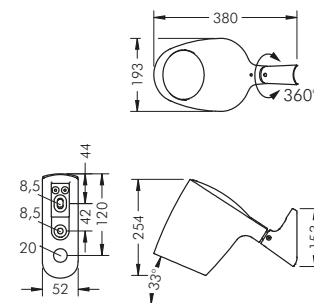

Monospot+ secondary reflector, narrow beam

Part number	Colour	Weight	Light source	Luminous flux	Beam angle γ (FWHM)
8 946 246 019	black	4.2 kg	1 x LED module 53 W warm white (3000 K)	3083 lm	10°
8 946 266 019	white				
8 946 256 019	silver grey				

Monospot+ secondary reflector, medium wide beam

Part number	Colour	Weight	Light source	Luminous flux	Beam angle γ (FWHM)
8 946 246 049	black	4.2 kg	1 x LED module 53 W warm white (3000 K)	3388 lm	26°
8 946 266 049	white				
8 946 256 049	silver grey				

Monospot+ secondary reflector, wide beam

Part number	Colour	Weight	Light source	Luminous flux	Beam angle γ (FWHM)
8 946 246 059	black	4.2 kg	1 x LED module 53 W warm white (3000 K)	3549 lm	66°
8 946 266 059	white				
8 946 256 059	silver grey				

Part number	Description
... 5 ...	Monospot+ secondary reflector (27 W)
... 7 ...	Protection class II luminaire (27 W)
... 8 ...	Protection class II luminaire (53 W)
... .. 7 ...	Luminaire with warm white LED module (2700 K)
... .. 8 ...	Luminaire with warm white LED module (2200 K)
... .. 1 ..	Dimmable luminaire (DALI)
... .. 2 ..	Dimmable luminaire (DALI D4i)
... .. 3 ..	Luminaire with Zhaga-18 interface
... 4 ...	Wall mounted luminaire

Accessories Monospot+ external, for retro-fitting

Part number	Colour	Description
129 0 990 940	black	Cowl length 52 mm , die cast aluminium, polyester powder coated, to avoid lateral glare, for retro-fitting
129 0 990 960	white	
129 0 990 950	silver grey	

Accessories Monospot+ internal, factory fitted*

Part number	Description
129 0 729 940	Radial louvre , internal (factory fitted)
129 0 753 000	Honeycomb louvre , internal (factory fitted)

* not available for asymmetrical beam, Street Optic and secondary reflector

Accessories Monospot+

\varnothing 60 mm		\varnothing 76 mm	
Part number	Part number	Colour	Description
120 0 699 940	120 0 700 940	black	Post-top fitter for insertion, with Zhaga 18-interface, with 8 m cable, for control and monitoring of max. 4 luminaires with D4i LED driver
120 0 699 960	120 0 700 960	white	
120 0 699 950	120 0 700 950	silver grey	

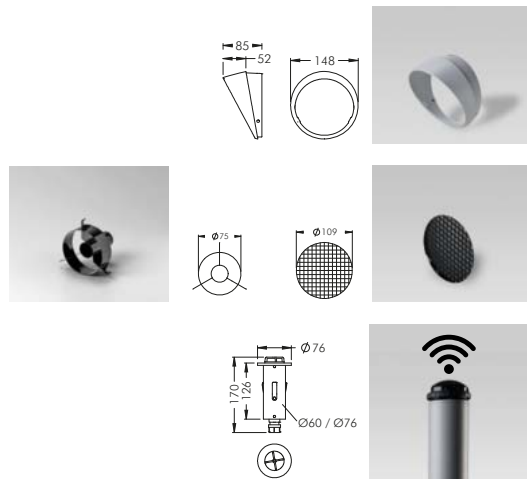

Luminaires available in other colour temperatures upon request

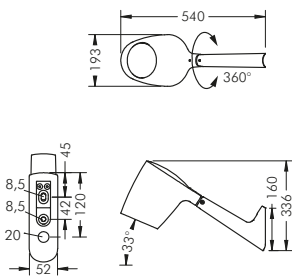

Monospot+ pole luminaire with arm

With high performance LED module (Zhaga), integral temperature monitoring device, CRI: > 80, Colour tolerance: 2 SDCM
 Service life: L80/B10 > 50 000 h
 protection class I or II, IP65 \blacklozenge \blacktriangle \blacktriangle , IK08
 windage area AW 0.059 m²
 corrosion-resistant die cast aluminium housing AlSi12, polyester powder coated,
 highly efficient aluminium reflector or PMMA lens (Street Optic),
 all exterior steel parts are stainless steel, tempered safety glass, silicon gasket,
 closure with 3 stainless steel screws, tiltable base made of powder coated aluminium,
 mounting base:
 2 drilled holes \varnothing 8.5 mm, spacing 42 mm,
 1 centre hole \varnothing 20 mm, tilt range 33°, swivel range 360°, M20 cable gland,
 integral driver (AC/DC)

Monospot+ with arm, narrow beam

Part number	Colour	Weight	Light source	Luminous flux	Beam angle γ (FWHM)
8 996 346 019	black	4.6 kg	1 x LED module 53 W warm white (3000 K)	4453 lm	10°
8 996 366 019	white				
8 996 356 019	silver grey				

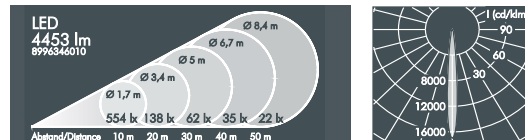

Monospot+ with arm, linear beam spread, vertical

Part number	Colour	Weight	Light source	Luminous flux	Beam angle γ (FWHM)
8 996 346 029	black	4.6 kg	1 x LED module 53 W warm white (3000 K)	4230 lm	C 0 – 180
8 996 366 029	white				C 90 – 270
8 996 356 029	silver grey				37°

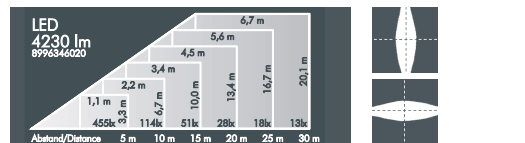

Monospot+ with arm, linear beam spread, horizontal

Monospot+ with arm, linear beam spread, rotatable

Part number	Colour	Description	Luminous flux	Beam angle γ (FWHM)
8 996 346 079	black	Luminaire with external ribbed glass spreader lens, continuously adjustable through 360° from outside the luminaire	3794 lm	C 0 – 180
8 996 366 079	white			C 90 – 270
8 996 356 079	silver grey			37°

Weight 4.7 kg

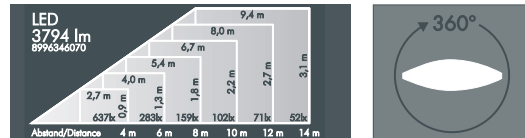

Monospot+ with arm, medium wide beam

Part number	Colour	Weight	Light source	Luminous flux	Beam angle γ (FWHM)
8 996 346 049	black	4.6 kg	1 x LED module 53 W warm white (3000 K)	4447 lm	30°
8 996 366 049	white				
8 996 356 049	silver grey				

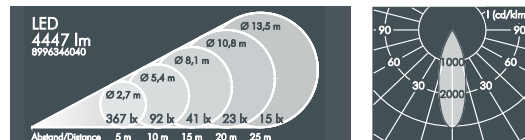

Monospot+ with arm, wide beam

Part number	Colour	Weight	Light source	Luminous flux	Beam angle γ (FWHM)
8 996 346 059	black	4.6 kg	1 x LED module 53 W warm white (3000 K)	4523 lm	53°
8 996 366 059	white				
8 996 356 059	silver grey				

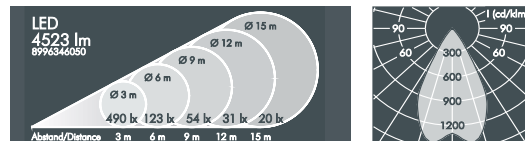

Monospot+ with arm, asymmetrical beam

Part number	Colour	Weight	Light source	Luminous flux	Main beam angle γ
8 996 346 099	black	5.4 kg	1 x LED module 53 W warm white (3000 K)	2966 lm	38°
8 996 366 099	white				
8 996 356 099	silver grey				

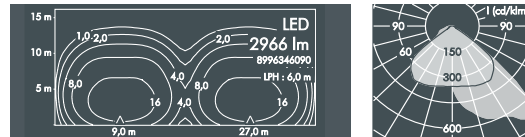

Monospot+ with arm, Street Optic

Part number	Colour	Weight	Light source	Luminous flux	Beam angle γ (FWHM)
8 996 346 089	black	5.4 kg	1 x LED module 53 W warm white (3000 K)	3764 lm	C 0 – 180
8 996 366 089	white				C 90 – 270
8 996 356 089	silver grey				117°

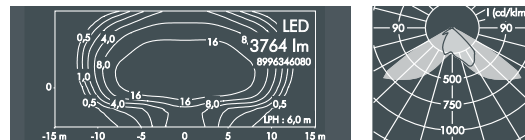

Part number	Description
...5...	Monospot+ with arm (27 W)
...7...	Protection class II luminaire (27 W)
...8...	Protection class II luminaire (53 W)
...7...	Luminaire with warm white LED module (2700 K)
...8...	Luminaire with warm white LED module (2200 K)
...1...	Dimmable luminaire (DALI)
...2...	Dimmable luminaire (DALI D4i)
...3...	Luminaire with Zhaga-18 interface

Luminaires available
 in other colour temperatures upon request

Monospot+ pole luminaire with arm and secondary reflector

With high performance LED module (Zhaga), integral temperature monitoring device, CRI: > 80, Colour tolerance: 2 SDCM
 Service life: L80/B10 > 50 000 h
 protection class I or II, IP65 , IK08
 windage area AW 0.059 m²
 corrosion-resistant die cast aluminium housing AlSi12, polyester powder coated, enhanced glare control with primary and secondary reflector, all exterior steel parts are stainless steel, tempered safety glass, silicon gasket, closure with 3 stainless steel screws, tiltable base made of powder coated aluminium, mounting base:
 2 drilled holes \varnothing 8.5 mm, spacing 42 mm, 1 centre hole \varnothing 20 mm, tilt range 33°, swivel range 360°, M20 cable gland, integral driver (AC/DC)

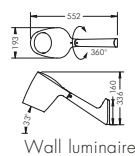
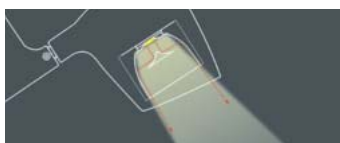
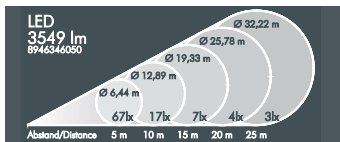
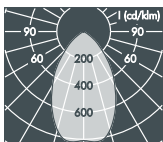
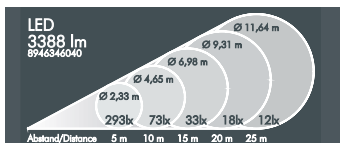
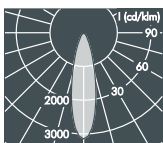
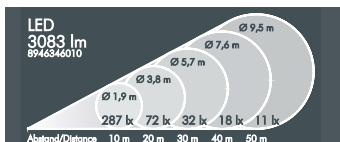
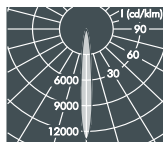
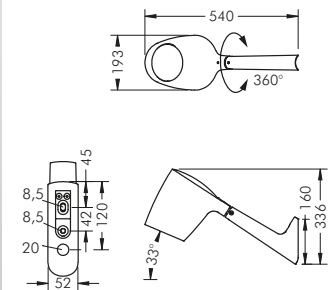

Wall luminaire

Monospot+ secondary reflector and pole arm, narrow beam

Part number	Colour	Weight	Light source	Luminous flux	Beam angle γ (FWHM)
8 946 346 019	black	4.7 kg	1 x LED module 53 W warm white (3000 K)	3083 lm	10°
8 946 366 019	white				
8 946 356 019	silver grey				

Monospot+ secondary reflector and pole arm, medium wide beam

Part number	Colour	Weight	Light source	Luminous flux	Beam angle γ (FWHM)
8 946 346 049	black	4.7 kg	1 x LED module 53 W warm white (3000 K)	3388 lm	26°
8 946 366 049	white				
8 946 356 049	silver grey				

Monospot+ secondary reflector and pole arm, wide beam

Part number	Colour	Weight	Light source	Luminous flux	Beam angle γ (FWHM)
8 946 346 059	black	4.7 kg	1 x LED module 53 W warm white (3000 K)	3549 lm	66°
8 946 366 059	white				
8 946 356 059	silver grey				

Part number	Description
... 5 ...	Monospot+ secondary reflector and pole arm (27 W)
... 7 ...	Protection class II luminaire (27 W)
... 8 ...	Protection class II luminaire (53 W)
... .. 7 ...	Luminaire with warm white LED module (2700 K)
... .. 8 ...	Luminaire with warm white LED module (2200 K)
... .. 1 ..	Dimmable luminaire (DALI)
... .. 2 ..	Dimmable luminaire (DALI D4i)
... .. 3 ..	Luminaire with Zhaga-18 interface
... 5 ...	Wall mounted luminaire

Accessories Monospot+ external, for retro-fitting

Part number	Colour	Description
129 0 990 940	black	Cowl length 52 mm , die cast aluminium, polyester powder coated, to avoid lateral glare, for retro-fitting
129 0 990 960	white	
129 0 990 950	silver grey	

Accessories Monospot+ internal, factory fitted*

Part number	Description
129 0 729 940	Radial louvre , internal (factory fitted)
129 0 753 000	Honeycomb louvre , internal (factory fitted)

* not available for asymmetrical beam, Street Optic and secondary reflector

Accessories Monospot+

\varnothing 60 mm		\varnothing 76 mm	
Part number	Part number	Colour	Description
120 0 699 940	120 0 700 940	black	Post-top fitter for insertion, with Zhaga 18-interface, with 8 m cable, for control and monitoring of max. 4 luminaires with D4i LED driver
120 0 699 960	120 0 700 960	white	
120 0 699 950	120 0 700 950	silver grey	

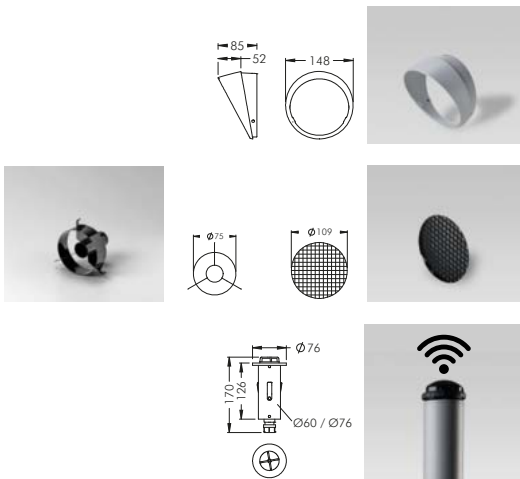

Luminaires available in other colour temperatures upon request