



Monospot is a floodlight series with innovative technology and design. It comes in 5 sizes with varying wattages. Since the LED modules are located deep inside the reflectors, the luminaires have good cut-off and excellent glare control. In addition to a wide range of fixed light distributions, there is also the Vario Optic version which allows the light beam to be adjusted to suit the specific lighting task. The housings are free of joins and ridges, in or on which dirt and dust can collect. The puristic design and the compact dimensions allow these products to be integrated discreetly into any architectural surrounding.

For the Monospot series there is a gobo projector available with precise optics for sharp-edged image projections. The optical system can accommodate gobos and colour filters simultaneously. With the help of a framer, the edges of the image can be defined and adapted to the size of the projection surface. The Monospot series thus offers many possibilities for imaginative illumination.

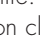

Monospot Gobo

With high performance LED module, CRI: > 70, colour tolerance: max. 4 SDCM
 Service life: L70/B20 > 50 000 h
 protection class I, IP65 , IK08
 windage area AW 0.074 m²,
 corrosion-resistant die cast aluminium housing AlSi12, polyester powder coated, focusable lens, carrier for gobos and colour filters, all exterior steel parts are stainless steel, tempered safety glass, silicon gasket, closure with 3 stainless steel screws, mounting bracket: 2 drilled holes Ø 7 mm, spacing 40-60 mm, 1 centre hole Ø 21 mm, tilt range 180°, M20 cable gland, integral driver (AC/DC)

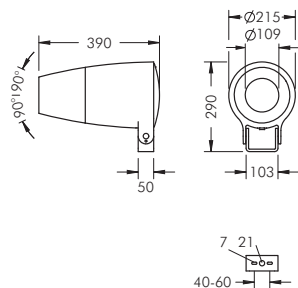

Monospot Gobo, 63 mm focal length

Part number	Colour	Weight	Light source	Luminous flux	Beam angle
8 905 044 059	black	6.7 kg	1 x LED module 47 W cool white (6500 K)	1000 lm	30°
8 905 064 059	white				
8 905 054 059	silver grey				

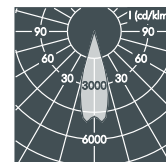
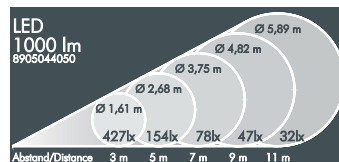

Monospot Gobo, 85 mm focal length

Part number	Colour	Weight	Light source	Luminous flux	Beam angle
8 905 044 049	black	6.7 kg	1x LED module 47 W cool white (6500 K)	1095 lm	20°
8 905 064 049	white				
8 905 054 049	silver grey				

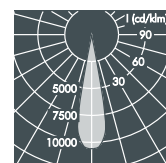
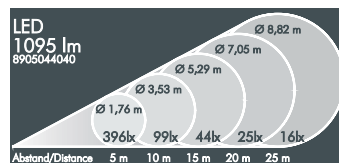

Monospot Gobo, 150 mm focal length

Part number	Colour	Weight	Light source	Luminous flux	Beam angle
8 905 044 019	black	6.7 kg	1x LED module 47 W cool white (6500 K)	907 lm	12°
8 905 064 019	white				
8 905 054 019	silver grey				

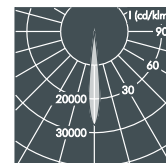
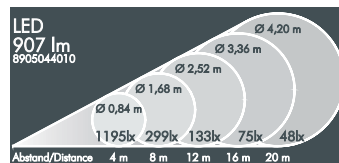

Part number	Description
. 1..	Dimmable version (DALI)
. 2..	Dimmable version (1-10 V)

Accessories Monospot Gobo

Part number	Colour	Description
129 0 551 000	yellow	Dichroic colour filter
129 0 557 000	red	
129 0 553 000	blue	
129 0 558 000	green	

Part number	Description
129 0 780 000	Fraser for sharp edges on 3- or 4-sided images

Part number	Example	Description
129 0 489 000	waves	Standard gobos Ø 50 mm
129 0 490 000	stars	
129 0 491 000	hash	

Custom made gobos can be produced from image data in one of the following file formats: **EPS** (min. 300 dpi), **TIF** (min. 300 dpi), **JPG** (in low compression).
 Max. image size D on gobo: D = 38 mm (outer diameter gobo 50 mm)

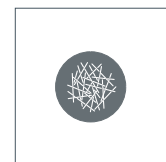
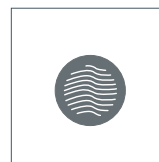

LED (see page 247)



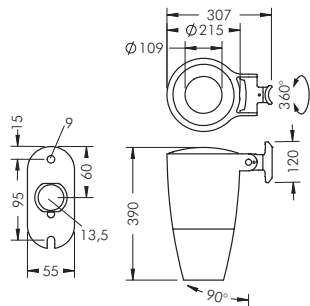

Monospot Gobo pole luminaire

With high performance LED module, CRI: > 70, colour tolerance: max. 4 SDCM service life: L70/B20 > 50 000 h protection class I, IP65 , IK08 windage area AW 0.076 m², corrosion-resistant die cast aluminium housing AlSi12, polyester powder coated, focusable lense, carrier for gobos and colour filters, all exterior steel parts are stainless steel, tempered safety glass, silicon gasket, closure with 3 stainless steel screws, for installation on poles Ø 60 - 100 mm, tilttable base made of powder coated aluminium, 2 drilled holes Ø 9 mm, spacing 95 mm, 1 drilled hole Ø 13.5 mm, tilt range 90°, swivel range 360°, M20 cable gland, integral driver (AC/DC)

Monospot Gobo pole luminaire, 63 mm focal length

Part number	Colour	Weight	Light source	Luminous flux	Beam angle
8 905 244 059	black	7.0 kg	1 x LED module 47 W cool white (6500 K)	1000 lm	30°
8 905 264 059	white				
8 905 254 059	silver grey				

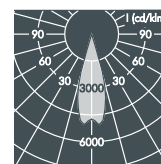
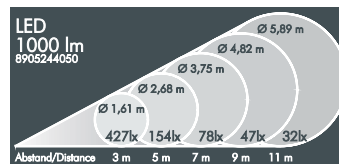

Monospot Gobo pole luminaire, 85 mm focal length

Part number	Colour	Weight	Light source	Luminous flux	Beam angle
8 905 244 049	black	7.0 kg	1 x LED module 47 W cool white (6500 K)	1095 lm	20°
8 905 264 049	white				
8 905 254 049	silver grey				

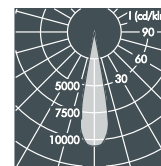
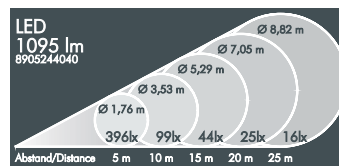

Monospot Gobo pole luminaire, 150 mm focal length

Part number	Colour	Weight	Light source	Luminous flux	Beam angle
8 905 244 019	black	7.0 kg	1 x LED module 47 W cool white (6500 K)	907 lm	12°
8 905 264 019	white				
8 905 254 019	silver grey				

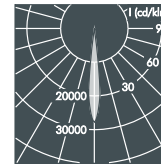
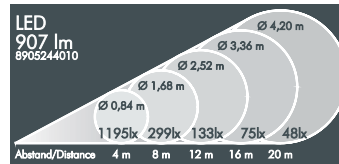

Part number	Description
. 1..	Dimmable version (DALI)
. 2..	Dimmable version (1-10 V)

LED (see page 247)



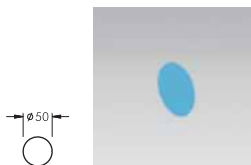

Accessories Monospot Gobo

Part number	Colour	Description
129 0 551 000	yellow	Dichroic colour filter
129 0 557 000	red	
129 0 553 000	blue	
129 0 558 000	green	



Part number	Description
129 0 780 000	Framer for sharp edges on 3- or 4-sided images



Part number	Example	Description
129 0 489 000	waves	Standard gobos Ø 50 mm
129 0 490 000	stars	
129 0 491 000	hash	

Custom made gobos can be produced from image data in one of the following file formats: **EPS** (min. 300 dpi), **TIF** (min. 300 dpi), **JPG** (in low compression).
Max. image size D on gobo: D = 38 mm (outer diameter gobo 50 mm)

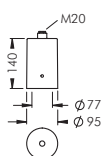
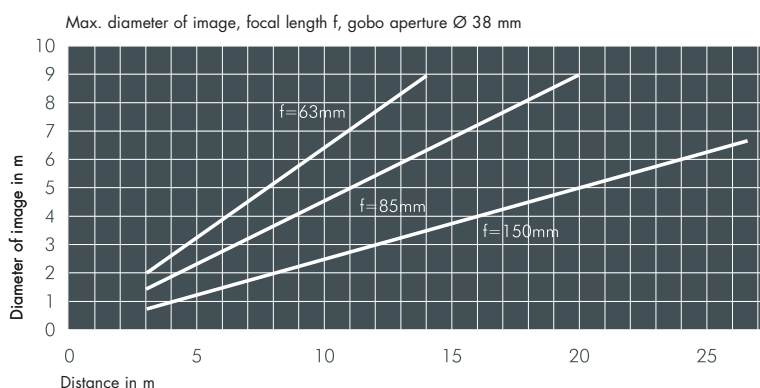

Part number	Colour	Description
128 0 626 940	black	Pole Top Filter , aluminium, for 76 mm pole top, with M20 x 1.5 connection thread, for installation of one projector with mounting bracket
128 0 626 960	white	
128 0 626 950	silver grey	

