



ANGLE MOUNTED
TITAN

TITAN A45 / TITAN A30



Specifications:

- Luminaire resistant to extreme vandalism
- Linear versions with 45° angle (Titan A45) and 30° angle (Titan A30)
- 1 mm thick zinc-coated steel body protected against corrosion
- 2 mm thick zinc-coated steel frame protected against corrosion
- Polyester powder coating
- Clear textured polycarbonate diffuser (fluorescence)
- Opal polycarbonate diffuser (LED)
- Tamperproof stainless steel screws

● RAL7016

○ RAL9003
White colour on request

Options:
(please contact us)

Class II
Separate circuit
Duroflam® diffuser
Opal polycarbonate diffuser
1W or 3W LED night light
Built-in microwave motion detection
Daylight sensor (preset to 70 lux)

EXISTING INSTALLATIONS:

Switch to LED!
see p. 202 - 203

LED module:

- 6 x 1.5 W LED module
- Mounted on aluminium heat dissipation plate
- Average colour temperature: 3800 K / IRC (Ra) > 80
- LED power supply: constant voltage 24 V DC
- Total module power: 9.50 W
- Average service life 50000 hours at 25 °C ambient temperature

Corridor function:

By default, the Corridor function provides standby lighting by reducing the luminous flux to 10% of its rated value.
On request, we can also preset the fittings to operate with a switch-off warning signal, i.e. to reduce then stop the luminous flux.

Light fittings without built-in motion sensor:
The Corridor function can be activated by another master luminaire, a remote detector, a timer switch or a daylight sensor.

Dimmable fluorescence (EEI = A1):

Three types of controls are included in the samedimmable HF ballast:
DALI, DSI, or SWITCH-DIM (momentary push-button switch operated).

HF ballast (EEI = A2):

- Warm cathode HF ballast
- Non dimmable
- Power factor cos phi > 0.95

TITAN A45

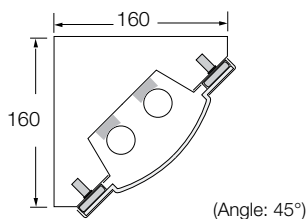

LED

220-240 V AC / 50 Hz RoHS

	Number of 6 x LED modules	Wattage	Length (mm)	Equivalence ^(*)	Code
	2	23 W	720	1 x 18 W	LD1300
	4	46 W	720	2 x 18 W	LD1301
	4	46 W	1 330	1 x 36 W	LD1302
	8	92 W	1 330	2 x 36 W	LD1303
	6	69 W	1 630	1 x 58 W	LD1304
	12	138 W	1 630	2 x 58 W	LD1305

(*) Equivalences given for information only.

FLUORESCENCE

220-240 V AC / 50 Hz RoHS

LAMP		Length L (mm)	Conventional ballast	HF ballast	DALI dimming + Corridor function ⁽¹⁾
1 x 18 W T8	G13	720	LD6461	LD6461-BHF	LD6461-BHD
2 x 18 W T8	G13	720	LD6460	LD6460-BHF	LD6460-BHD
1 x 36 W T8	G13	1 330	LD6459	LD6459-BHF	LD6459-BHD
2 x 36 W T8	G13	1 330	LD6458	LD6458-BHF	LD6458-BHD
1 x 58 W T8	G13	1 630	LD6457	LD6457-BHF	LD6457-BHD
2 x 58 W T8	G13	1 630	LD6456	LD6456-BHF	LD6456-BHD
1 x 14 W-24 W T5	G5	720	-	LD6500	LD6500-BHD
2 x 14 W-24 W T5	G5	720	-	LD6502	LD6502-BHD
1 x 28 W-54 W T5	G5	1 330	-	LD6504	LD6504-BHD
2 x 28 W-54 W T5	G5	1 330	-	LD6506	LD6506-BHD
1 x 35 W-49 W T5	G5	1 630	-	LD6508	LD6508-BHD
2 x 35 W-49 W T5	G5	1 630	-	LD6510	LD6510-BHD

(1) Requires external control (remote motion sensor or other master luminaire, etc.) to activate the Corridor function.

Tamperproof tool see pages 204-205.

TITAN A30

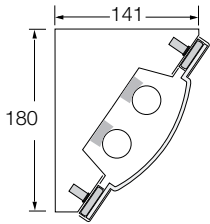

(Angle: 30° / 60°)

LED

220-240 V AC / 50 Hz RoHS

	Number of 6 x LED modules	Wattage	Length (mm)	Equivalence ^(*)	Code
	2	23 W	720	1 x 18 W	LD1400
	4	46 W	720	2 x 18 W	LD1401
	4	46 W	1 330	1 x 36 W	LD1402
	8	92 W	1 330	2 x 36 W	LD1403
	6	69 W	1 630	1 x 58 W	LD1404
	12	138 W	1 630	2 x 58 W	LD1405

(*) Equivalences given for information only.

FLUORESCENCE

220-240 V AC / 50 Hz RoHS

LAMP		Length L (mm)	Conventional ballast	HF ballast	DALI dimming + Corridor function ⁽¹⁾
1 x 18 W T8	G13	720	LD6449	LD6449-BHF	LD6449-BHD
2 x 18 W T8	G13	720	LD6448	LD6448-BHF	LD6448-BHD
1 x 36 W T8	G13	1 330	LD6447	LD6447-BHF	LD6447-BHD
2 x 36 W T8	G13	1 330	LD6446	LD6446-BHF	LD6446-BHD
1 x 58 W T8	G13	1 630	LD6445	LD6445-BHF	LD6445-BHD
2 x 58 W T8	G13	1 630	LD6444	LD6444-BHF	LD6444-BHD
1 x 14 W-24 W T5	G5	720	-	LD6550	LD6550-BHD
2 x 14 W-24 W T5	G5	720	-	LD6552	LD6552-BHD
1 x 28 W-54 W T5	G5	1 330	-	LD6554	LD6554-BHD
2 x 28 W-54 W T5	G5	1 330	-	LD6556	LD6556-BHD
1 x 35 W-49 W T5	G5	1 630	-	LD6558	LD6558-BHD
2 x 35 W-49 W T5	G5	1 630	-	LD6560	LD6560-BHD

(1) Requires external control (remote motion sensor or other master luminaire, etc.) to activate the Corridor function.

Tamperproof tool see pages 204-205.